

CERTIFIED RECORD OF LAND CORNER MONUMENTATION

A-7
~~Z-7~~

History of original corner establishment:

This corner was originally established by Frank W. Campbell on July 14, 1883, under contract No. 468, as follows:

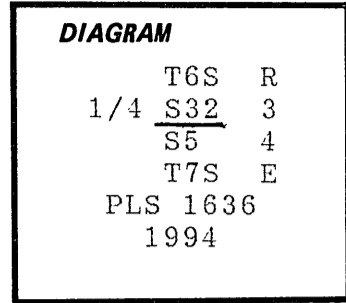

Set a post for the corner, from which:

- A 10" Tamarack bears N45° E, 14 links.
 - A 11" Tamarack bears S40° E, 20 links.
- Both properly blazed and scribed.

Description of corner evidence found:

The original 10" Tamarack is a live 14" Western Larch with a large single healed blaze. I open blaze and find scribes "1/4S". Bears N45°E, 9.24 feet. The original 11" Tamarack is gone, as is the original corner post.

Description of monument and accessories I established to perpetuate the original location of this corner:

At record bearing and distance from the one remaining original bearing tree, I set a 2 1/2" x 30" aluminum pipe 25" into the ground in a small mound of stones. A 3 1/4" aluminum cap attached is marked as shown in the diagram above. From which:

- A 10" Western Larch bears S62° E, 23.1 feet scribed "1/4S5 BT".
- A 15" Western Larch bears N24° E, 45.3 feet scribed "1/4S32 BT".
- A 14" Western Larch bears N27° 15'W, 28.9 feet scribed "1/4S32 BT".
- A 24" White Fir bears S20° 30'W, 53.9 feet scribed "1/4S5 BT".

All bearing trees have a sign 54-3, "Bearing Tree", nailed above the blazes and a sign 54-9, "Land Survey Monument", nailed to the back. The new bearing trees are scribed on double blazes and have a 5/8" brass washer, marked "PLS 1636", nailed flush to the scribed "B".

I hereby certify the above corner point was perpetuated as hereon descibed on September 7, 1994.

Magnetic declination: 20° E.

NAD1983 Geographic position (+ or - 2 to 6 meters):
Latitude: 44-59-50.53N
Longitude: 118-38-49.11W

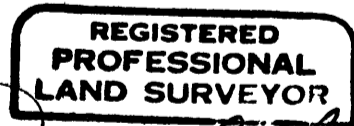

Dennis L. Gaylord

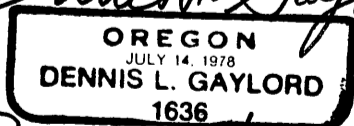

Renews 6/30/95

Office of COUNTY SURVEYOR County of GRANT
 State of OREGON, I hereby certify that the within instrument was filed in this office
 for record on the 28 day of Sept, 1994
Robert D. [Signature] by _____
 (COUNTY OFFICIAL) (DEPUTY)

A-7